

1.	MATERIAL : <u>HOUSING</u> PBT POLYESTER, BLACK, UL 94V-0.	E1	REVISED PER ECO-21-000623	28 JUL 2020	IT
	<u>TERMINALS</u> 0.33 THICK PHOSPHOR BRONZE PLATED WITH 1.27 μ m MINIMUM THICK HARD GOLD IN LOCALIZED AREA AND 3.81 μ m MINIMUM THICK MATTE TIN IN ACTION PIN COMPLIANT PIN TERMINAL AREA OVER 1.27 μ m MINIMUM THICK NICKEL UNDERPLATE.				
	<u>SHIELD</u> 0.25 THICK COPPER ALLOY PLATED WITH 1.27 μ m MINIMUM NICKEL <u>LIGHT EMITTING DIODE (LED)</u> DIFFUSED EPOXY LENS, 12.95 CARBON STEEL WIREFRAME LEADS PREPLATED WITH 8.89 μ m THICK Sn/Cu OVER 2.03 μ m THICK Ag OVER 1.02 μ m THICK Cu OVER 3.56 μ m THICK Ni OVER 1.02 μ m THICK Cu UNDERPLATE				
	<u>LED ACTION PIN - COMPLIANT PIN CONTACTS</u> 0.3 THICK BRASS PLATED WITH 2 μ m MINIMUM MATTE TIN OVER 1.27 μ m MINIMUM NICKEL UNDERPLATE.				

2. JACK CAVITY CONFORMS TO FCC RULES AND REGULATIONS, PART 68 SUBPART F.

3. ALL DIMENSIONS ARE NOMINAL UNLESS OTHERWISE SPECIFIED.

4 DRILLED HOLE DIA = 1.02±.025.
COPPER THICKNESS = 0.025-0.075.
TIN LEAD THICKNESS = 0.008 MIN.

5 DATUMS AND BASIC DIMENSIONS ESTABLISHED BY CUSTOMER.

6 DATE CODE LOCATED ON REAR OF PART APPROXIMATELY AS SHOWN.

CONTACTS ARE NOT INTENDED TO BE ALIGNED WITH EACH OTHER.

8 SUGGESTED OPERATING CURRENT FOR LEDS IS 20 mA.

9. TWO LEDS PER PORT, SIZE .079 X .118, SEE TABLE FOR COLOR

10. CLEAR 0.038 MIN THICK SURFACE PROTECTION TAPE APPLIED TO SHIELD SURFACE. FILM DOES NOT HAVE CUTOUTS IN EACH PORT. REMOVE TAPE PRIOR TO MATING A MODULAR PLUG TO THE JACK

4. MATERIAL:
SHIELD
0.25 THICK COPPER ALLOY PLATED WITH 1.27 μ m MINIMUM
SATIN NICKEL.

12 THE PART NUMBER 6368062-7 IS PRELIMINARY.

13 ONLY FOR 6368062-8
CONTACT AREA LUBRICATED WITH BELLCORE APPROVED
LUBRICANT TECHNICAL REFERENCE GR-1217-CORE
ISSUE 1, NOVEMBER 1995.

④ THE PART 6368062-9 IS ONLY FOR CUSTOMER ZYNX
SPECIAL LED LUMINOUS INTENSITY REQUEST.(GREEN:13~20 mcd
YELLOW:6~9 mcd.)

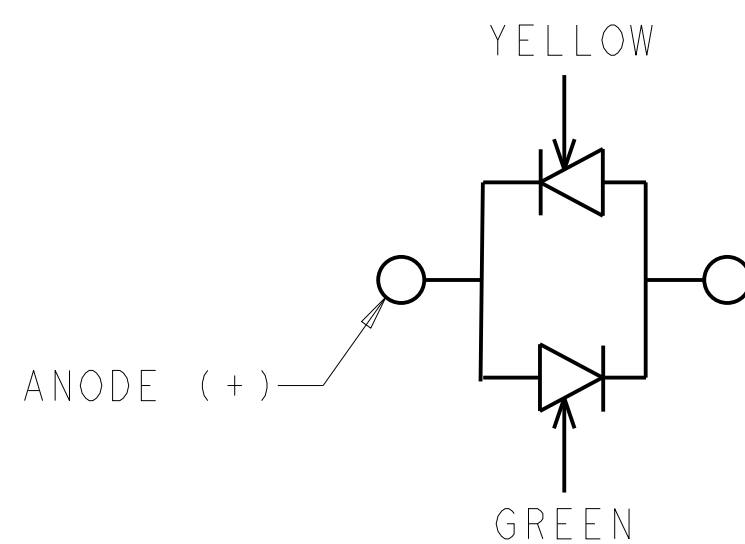

LED CURRENT DIAGRAM
6368062-4, -7

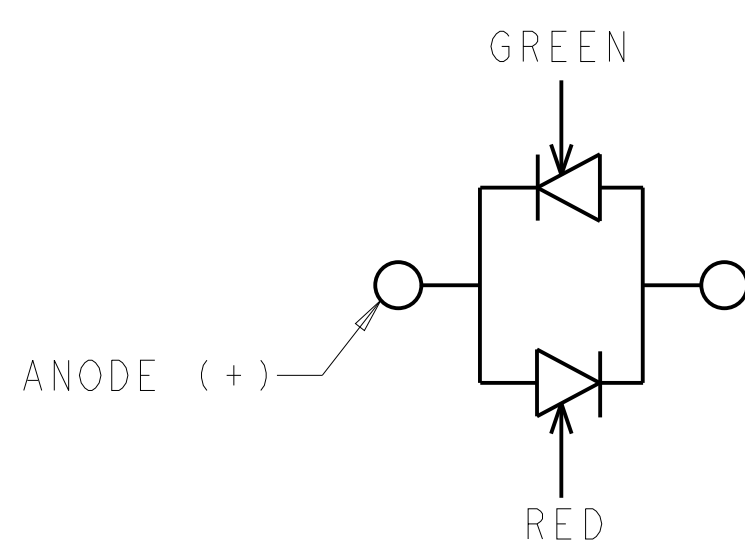

LED CIRCUIT DIAGRAM
6368062-6

PARTIAL BACK VIEW

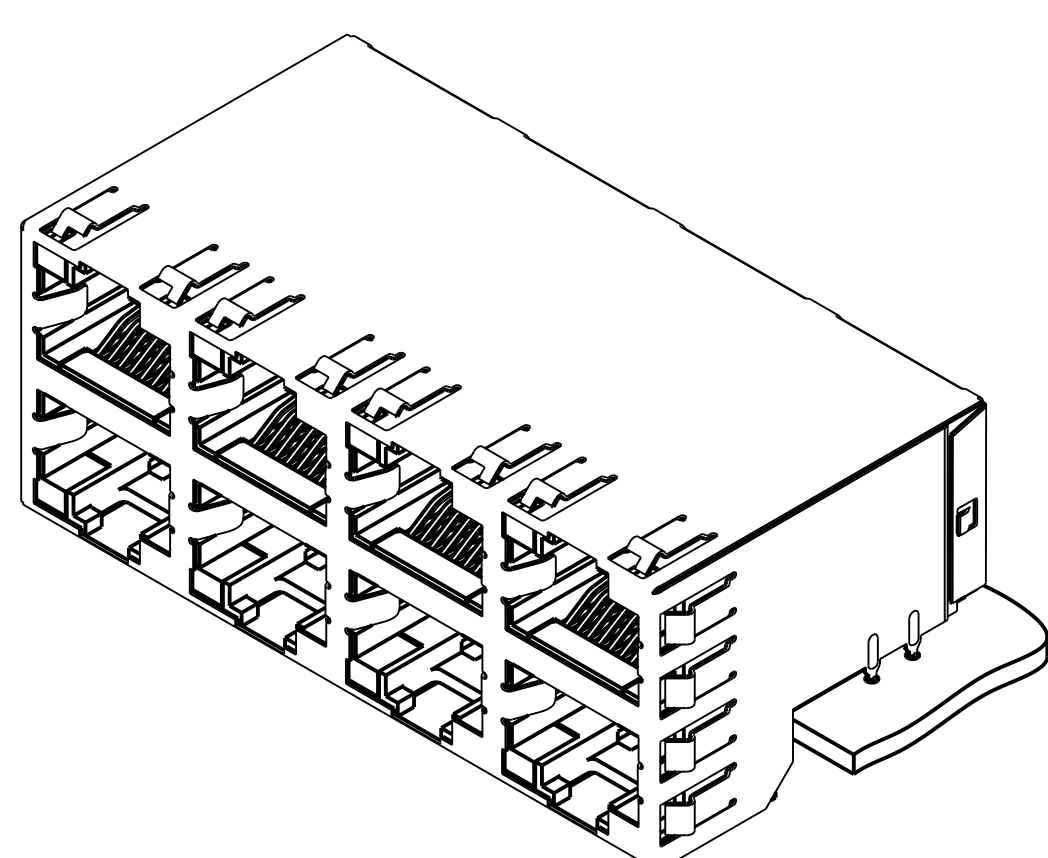

PN 6368062-1,-2,-3,-4,-5,-6,-8
AND 1-6368062-6
SCALE 2:1

PN 6368062-7
SCALE 2:1

	YELLOW	YELLOW	GREEN	GREEN	WITHOUT GROUND CLIP	1-6368062-6
	YELLOW	YELLOW	GREEN	GREEN	WITHOUT GROUND CLIP	6368062-9
	GREEN	GREEN	GREEN	GREEN	WITHOUT GROUND CLIP	6368062-8
-	N/A	N/A	GREEN/YELLOW	GREEN/YELLOW	WITHOUT GROUND CLIP	6368062-7 
-	RED/GREEN	RED/GREEN	RED/GREEN	RED/GREEN	WITH GROUND CLIP	6368062-6
	GREEN	GREEN	GREEN	GREEN	WITH GROUND CLIP	6368062-5
-	GREEN/YELLOW	GREEN/YELLOW	GREEN/YELLOW	GREEN/YELLOW	WITH GROUND CLIP	6368062-4
-	YELLOW	YELLOW	GREEN	GREEN	WITHOUT GROUND CLIP	6368062-3
-	GREEN	GREEN	GREEN	GREEN	WITH GROUND CLIP	6368062-2
-	GREEN	GREEN	GREEN	GREEN	WITHOUT GROUND CLIP	6368062-1
REMARKS	LED #4 (LOWER-RIGHT)	LED #3 (UPPER-RIGHT)	LED #2 (UPPER-LEFT)	LED #1 (LOWER-LEFT)	DESCRIPTION	PART NUMBER

THIS DRAWING IS A CONTROLLED DOCUMENT.		OWN L.A. MAYER	15APR2005						
		CNR WESTMAN	15APR2005			TE Connectivity			
DIMENSIONS:	TOLERANCES UNLESS OTHERWISE SPECIFIED:	APP'D S. FLICKINGER	15APR2005	NAME	STACKED MODULAR JACK ASSEMBLY, 2x4 OFFSET, WITH LEDS, 8 POSN, RJ45 SHIELDED, PANEL GROUNDS, CAT 5				
mm		PRODUCT SPEC							
	Ø PLC ± PLC ±0.13 Ø ±0.13 PLC ± Ø PLC ± ANGLES ±	108-1854 APPLICATION SPEC 114-2160		SIZE	CAGE CODE	DRAWING NO	RESTRICTED TO		
MATERIAL	FINISH	WEIGHT	-	A1	100779	G-6368062	-		
Customer Drawing				SCALE	4:1	SHEET	1 OF 2	REV E	

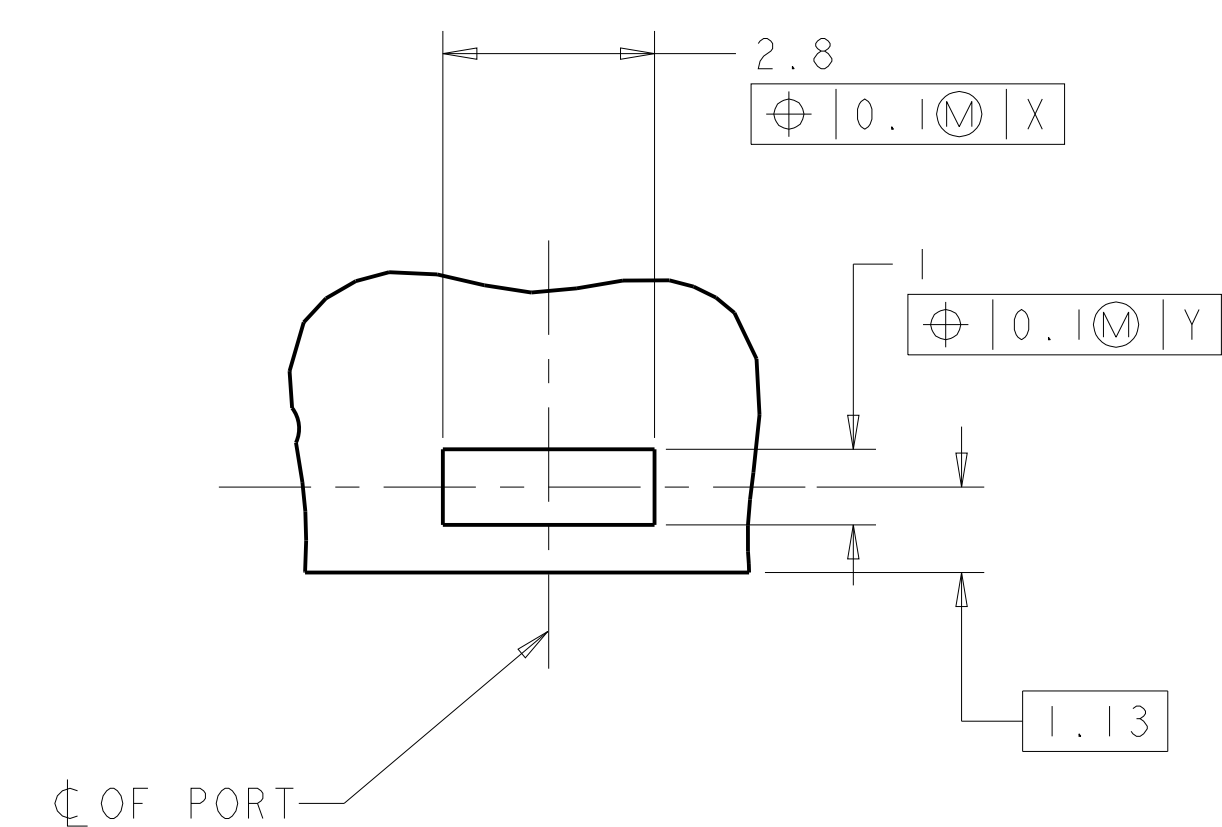

DETAIL B
PLATED PADS REQUIRED FOR 6368062-2, -4, -5 & -6
(PRODUCT WITH GROUNDING CLIPS)
SCALE 10:1
4 PLACES

PC BOARD LAYOUT
(COMPONENT SIDE)
LED #3,#4 NOT REQUIRED FOR 6368062-7

4805 (3/11)

Mouser Electronics

Authorized Distributor

Click to View Pricing, Inventory, Delivery & Lifecycle Information:

[TE Connectivity:](#)

[6368062-2](#)