

CX2045LNL

- Balun Transformer
- 1:2CT Impedance
- 3–300MHz
- Surface Mount

NOTES: UNLESS OTHERWISE SPECIFIED

1. OPERATING TEMPERATURE: -40°C TO $+85^{\circ}\text{C}$
2. STORAGE TEMPERATURE: -50°C TO $+125^{\circ}\text{C}$
3. JEDEC MOISTURE: LEVEL 1.
4. DIMENSIONS ARE IN INCHES WITH THE FOLLOWING TOLERANCE:
.XX= ± 0.01
.XXX= ± 0.005
5. OPTIONAL TAPE & REEL PACKAGING CAN BE ORDERED
BY ADDING A "T" SUFFIX TO THE PART NUMBER(EX: CX2045LNL T)
6. ROHS COMPLIANT



ELECTRICAL SPECIFICATIONS: $\odot 25^{\circ}\text{C}$

RETURN LOSS:

FREQUENCY	RETURN LOSS (S11)
3 MHz	-23.5 dB MIN
5 MHz	-25 dB MIN
9 MHz	-27 dB MIN
30 MHz	-27 dB MIN
50 MHz	-24.5 dB MIN

FREQUENCY	RETURN LOSS (S11)
90 MHz	-20 dB MIN
150 MHz	-16.5 dB MIN
220 MHz	-13.5 dB MIN
250 MHz	-12 dB MIN
300 MHz	-10.5 dB MIN

INSERTION LOSS:

FREQUENCY	ATTENUATION (S21)
3 MHz	-0.80 dB MAX
5 MHz	-0.80 dB MAX
9 MHz	-0.80 dB MAX
30 MHz	-0.80 dB MAX
50 MHz	-0.80 dB MAX

FREQUENCY	ATTENUATION (S21)
90 MHz	-0.80 dB MAX
150 MHz	-0.90 dB MAX
220 MHz	-1.00 dB MAX
250 MHz	-1.00 dB MAX
300 MHz	-1.00 dB MAX

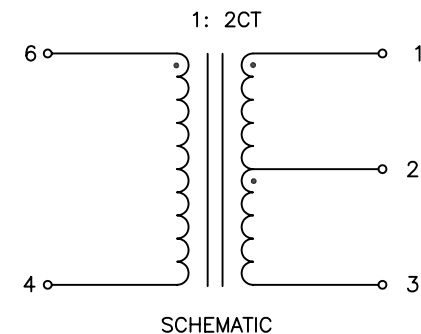

© Copyright, 2014. Pulse Electronics Corp. All rights reserved. Drawing specifications subject to change without notice. (02/14/14)

PULSE CONFIDENTIAL
&
PROPRIETARY

PRODUCT SPECIFICATION:
XFMR, RF, SGL, RAC, 1:2CT, 3–300MHz

DWG. NO./ PART NO.	SHEET:	REV.
CX2045LNL	1	M15

MECHANICAL SPECIFICATIONS:

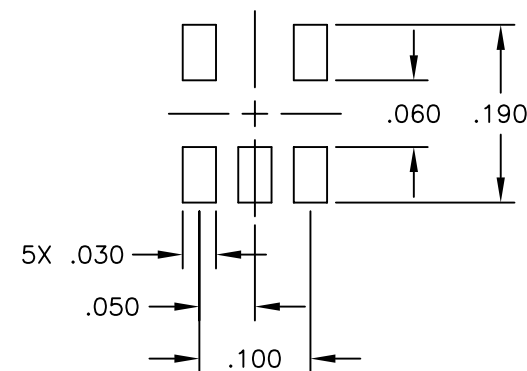
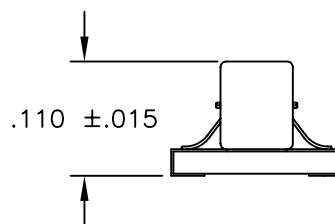
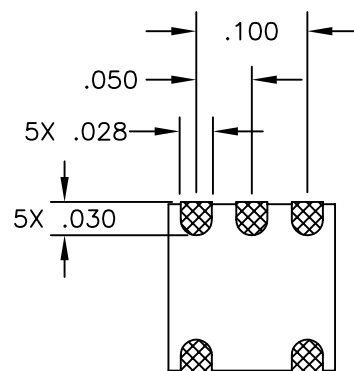
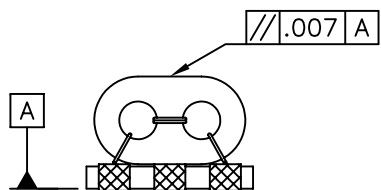
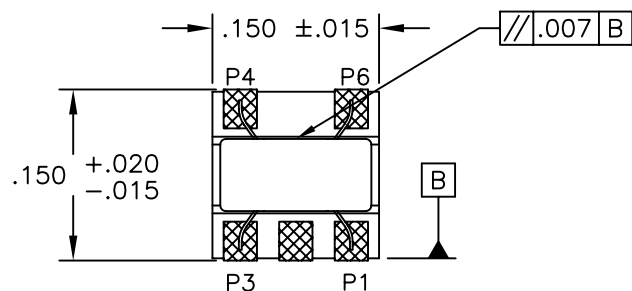

SUGGESTED LAND PATTERN

© Copyright, 2014. Pulse Electronics Corp. All rights reserved. Drawing specifications subject to change without notice. (02/14/14)

PULSE CONFIDENTIAL
&
PROPRIETARY

PRODUCT SPECIFICATION:

XFMR, RF, SGL, RAC, 1:2CT, 3-300MHz

DWG. NO./ PART NO.
CX2045LNL

SHEET:
2

REV.
M15

Mouser Electronics

Authorized Distributor

Click to View Pricing, Inventory, Delivery & Lifecycle Information:

Pulse:

[CX2045LNL](#) [CX2045LNLT](#)