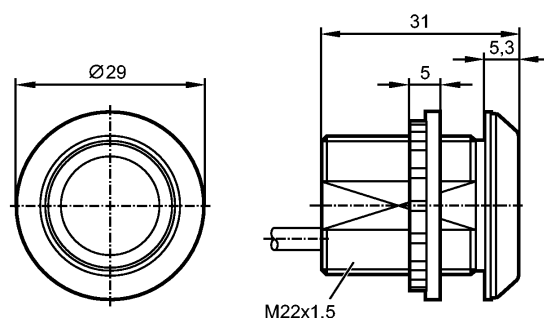

KT5106

KTRBFNUKBPKG/0.3M/SA/M22

Touch sensors

Made in Germany

Product characteristics

Touch sensor

Plastic housing

Cable with connector

Touch sensor with static evaluation principle

Diffuser to be ordered separately

Electrical data

| | |
|--------------------------|--------------------|
| Electrical design | DC PNP |
| Operating voltage [V] | 24 DC (12...30 DC) |
| Current consumption [mA] | 45 |

Outputs

| | |
|--------------------------|---------------|
| Output function | normally open |
| Current rating [mA] | 500 |
| Short-circuit protection | yes |
| Overload protection | yes |

Environment

| | |
|--------------------------|--------------------------------------|
| Ambient temperature [°C] | -40...85 |
| Protection | IP 65 / IP 67 / IP 69K; on the front |

Tests / approvals

| | |
|--------------|-----|
| MTTF [Years] | 352 |
|--------------|-----|

Mechanical data

| | |
|-------------------|-----------------|
| Housing materials | PA66 GF30 black |
| Weight [kg] | 0.056 |

Displays / operating elements

| | |
|------------------------------|-------|
| Output status indication LED | Red |
| Operation LED | green |

Electrical connection

| | |
|------------|---------------------------------------|
| Connection | PUR cable / 0.3 m; with M12 connector |
|------------|---------------------------------------|

Wiring

KT5106

KTRBFNUKBPKG/0.3M/SA/M22

Touch sensors

1: brown
3: blue
4: black

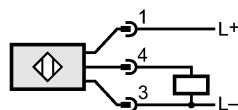

Accessories

Accessories (optional)

Diffuser

Remarks

| | | |
|---------------|---------|---|
| Pack quantity | [piece] | 1 |
|---------------|---------|---|

ifm electronic gmbh • Friedrichstraße 1 • 45128 Essen — We reserve the right to make technical alterations without prior notice. — GB — KT5106 — 11.02.2014