

SDS Series Side Actuated Detect Switches

NEW

Features/Benefits

- Low profile package sits just 2mm off PCB
- 2mm overtravel ideal for detector applications
- Low actuation force (75 grams max.)
- Pick & place compatible, available in tape & reel packaging
- Ultra low current capabilities
- RoHS compliant and compatible

Typical Applications

- Medical devices
- Consumer electronics
- PCB lock cam detect
- IoT devices
- ATCA and MicroTCA



Specifications

CONTACT RATING: 100mA @ 12 VDC

* For ULC version, min. current is 10µA @ 1.8 VDC

MECHANICAL & ELECTRICAL LIFE: 50,000 cycles

CONTACT RESISTANCE: 100 m Ω max. initial

INSULATION RESISTANCE: 10 M Ω min. @ 100 VDC

OPERATING TEMPERATURE: -40°C to +85°C

SOLDERABILITY: IR compatible, no wash. 260°C max.

PACKAGING: Bulk or tape & reel (3000 per reel)

Materials

BASE: Glass filled LCP (UL 94V-0)

ACTUATOR: Glass Filled LCP (UL94V-0)

COVER: Nickel silver w/silver plate

MOVABLE CONTACT: Phosphor bronze, see table for plating

TERMINALS: Phosphor bronze, see table for plating

NOTE: Specifications and materials listed above are for switches with standard options. For information on specific and custom switches, consult Customer Service Center.

How To Order

Our easy build-a-switch concept allows you to mix and match options to create the switch you need. To order, select desired option from each category and place it in the appropriate box.

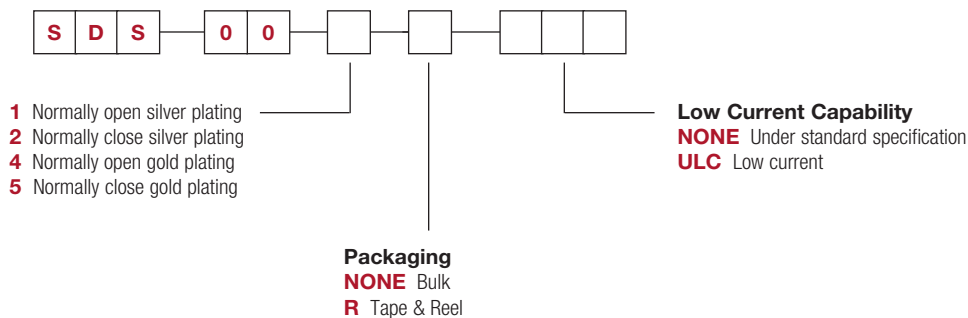





m

Detect

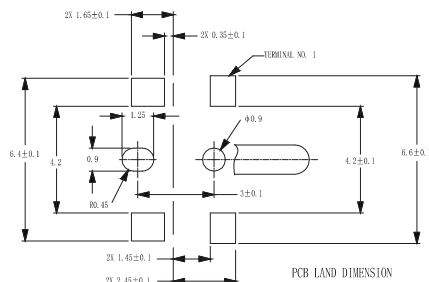
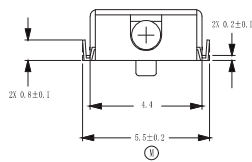
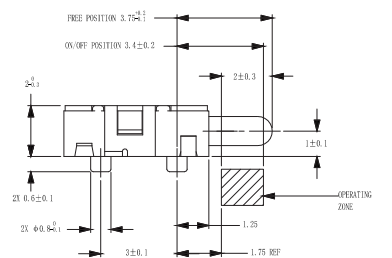
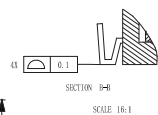
The technical drawing shows the PCB assembly with various dimensions and labels:

- Dimensions:**
 - Overall width: 8.5 ±0.1
 - Distance from left edge to center of terminal NO. 1: 2X 4.9
 - Distance between terminals: 2X 0.7 ±0.1
 - Distance from bottom edge to center of terminal NO. 2: 2X 3.75
 - Distance from center of terminal NO. 2 to right edge: 2X 0.6 ±0.1
 - Distance from center of terminal NO. 2 to center of terminal NO. 1: 2X 0.8 ±0.1
 - Radius of circular feature: R0.60 ±0.1
 - Diameter of circular feature: φ1.15 ±0.1
 - Overall height: 6
- Labels:**
 - TERMINAL NO. 1
 - TERMINAL NO. 2
 - B
 - SIL
 - Q1
 - C1
- Section View:**
 - SHEET SECTION D-D
 - SCALE 16:1



PART NUMBER	HOUSING COLOR	PACKAGING	SCHEMATIC	Contact Plating	Terminal Plating
SDS001	Black	Bulk		Silver Clad	Silver Plate
SDS001R		Tape & Reel	N.O.		
SDS001RULC					
SDS002	White	Bulk		Gold Flash	Gold Flash
SDS002R		Tape & Reel	N.C.		
SDS002RULC					
SDS004	Black	Bulk		Gold Flash	Gold Flash
SDS004R		Tape & Reel	N.O.		
SDS004RULC					
SDS005	White	Bulk		Gold Flash	Gold Flash
SDS005R		Tape & Reel	N.C.		
SDS005RULC					



SDS001
SPST

- a. PACKAGE QUANTITY: 3,000 PCS/REEL.
- b. SPECIFICATION OF TAPING PACKAGE: THE REEL CARRIER TAPE WILL HAVE A LEAD OF 33 EMPTY COMPONENT POCKETS AND AN END OF 14 EMPTY COMPONENT POCKETS ON EVERY REEL. ALL EMPTY COMPONENT POCKETS WILL BE SEALED WITH COVER TAPE.
- c. AFTER THE LEAD, NO REEL CARRIER TAPE SHALL HAVE TWO CONSECUTIVE EMPTY COMPONENT POCKETS.

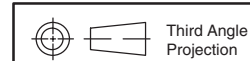
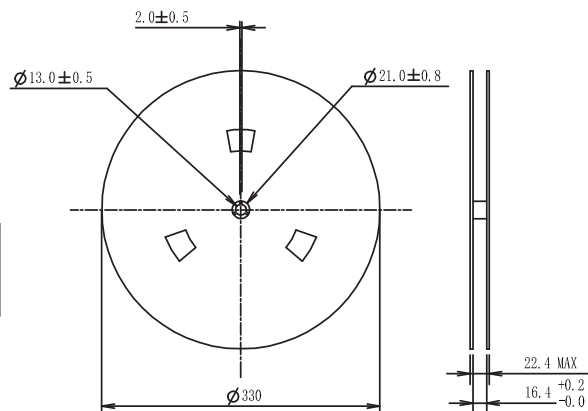
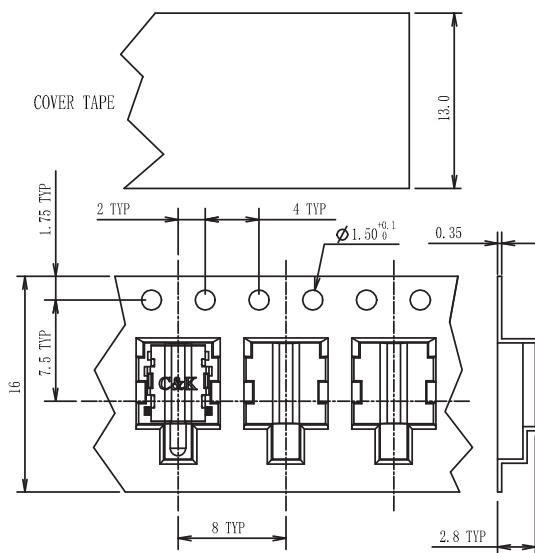

Dimensions are shown: mm
Specifications and dimensions subject to change

Mouser Electronics

Authorized Distributor

Click to View Pricing, Inventory, Delivery & Lifecycle Information:

C&K Switches:

[SDS001](#) [SDS005](#) [SDS001R](#) [SDS002](#) [SDS002R](#) [SDS004](#) [SDS004R](#) [SDS005R](#) [SDS001RULC](#) [SDS002RULC](#)
[SDS004RULC](#) [SDS005RULC](#)