

THIS DRAWING IS UNPUBLISHED.

RELEASED FOR PUBLICATION

20

© COPYRIGHT 20

BY -

ALL RIGHTS RESERVED.

REVISIONS

P	LTR	DESCRIPTION	DATE	DWN	APVD
	E	ECR-09-007414	02JUN2009	KG	DW
	F	ECR-17-001574	11APR2017	KG	DW

1. USE WITH FERRULE ASSEMBLY KIT P/N 1588908-2 (125um), OR 1588908-1 (126um).
QUANTITY OF 2 REQUIRED. FERRULE MUST BE PC-POLISHED DURING FIBER TERMINATION
FOR BEST PERFORMANCE.

2. PROTECTIVE LABEL APPLIED AFTER FINAL CLEAN ROOM TEST TO PREVENT
OPTICAL CAVITY CONTAMINATION. REMOVE ONLY WHEN READY TO ASSEMBLE.

3. SINGLEMODE IDENTIFIER.

4. FOR USE AT BOTH 1310 AND 1550nm WAVELENGTHS.

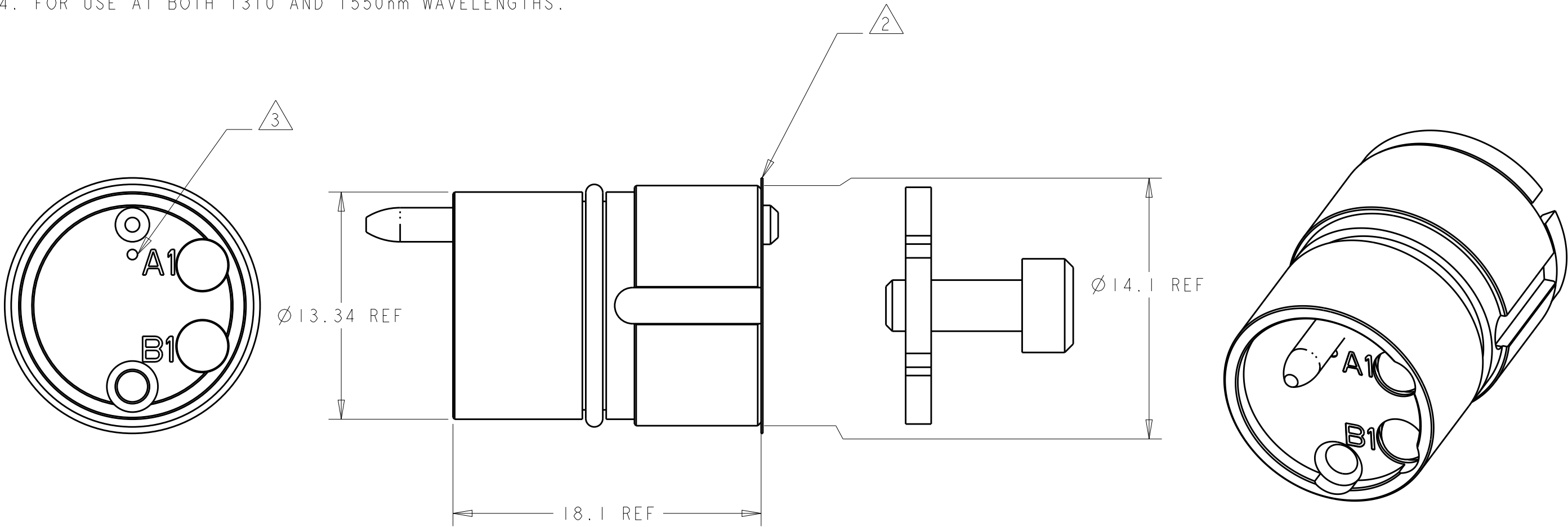

1515739-1

PART NO.

THIS DRAWING IS A CONTROLLED DOCUMENT.

DIMENSIONS:

mm

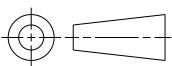

TOLERANCES UNLESS
OTHERWISE SPECIFIED:

0 PLC ±
1 PLC ±
2 PLC ±
3 PLC ±
4 PLC ±
ANGLES ±

MATERIAL
STAINLESS
ALLOYS & NBR

FINISH
N/A
-

DWN 08OCT2002

E. HOPKINS

CHK 08OCT2002

D. WERTMAN

APVD 08OCT2002

D. WERTMAN

PRODUCT SPEC

-

APPLICATION SPEC

-

WEIGHT

-

CUSTOMER DRAWING



TE Connectivity

NAME
INSERT ASSEMBLY, PRO BEAM JR.,
2x1310/1550nm SM

SIZE

CAGE CODE

DRAWING NO

RESTRICTED TO

A3

00779

C=1515739

-

SCALE

4:1

SHEET

OF

REV

F

Mouser Electronics

Authorized Distributor

Click to View Pricing, Inventory, Delivery & Lifecycle Information:

[TE Connectivity:](#)

[1515739-1](#)