

KT5102

KTRBFNUKBPKG/0.3M/DYN/M22

Touch sensors

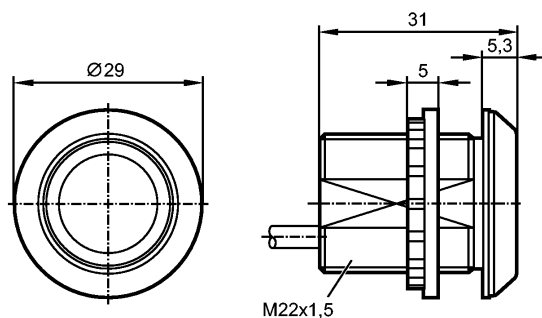

Made in Germany

Product characteristics

Touch sensor

Plastic housing

Cable with connector

Touch sensor with dynamic evaluation principle

Diffuser to be ordered separately

Electrical data

Electrical design	DC PNP
Operating voltage [V]	24 DC (12...30 DC)
Current consumption [mA]	45

Outputs

Output function	normally open
Current rating [mA]	500
Short-circuit protection	yes
Overload protection	yes

Reaction times

Duration of output signal [ms]	300
--------------------------------	-----

Environment

Ambient temperature [°C]	-40...85
Protection	IP 65 / IP 67 / IP 69K; on the front

Tests / approvals

MTTF [Years]	352
--------------	-----

Mechanical data

Housing materials	PA66 GF30 black
Weight [kg]	0.056

Displays / operating elements

Output status indication LED	Red
Operation LED	green

Electrical connection

Connection	PUR cable / 0.3 m; with M12 connector
------------	---------------------------------------

Wiring

KT5102

KTRBFNUKBPKG/0.3M/DYN/M22

Touch sensors

- 1: brown
- 3: blue
- 4: black

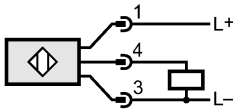

Accessories

Accessories (optional)	Diffuser
------------------------	----------

Remarks

Pack quantity	[piece]	1
---------------	---------	---